

**NOW  
AVAILABLE**



**MELLING**

# FORD TK, MAZDA, MERCURY

## **M328 HIGH VOLUME OIL PUMP**

**Jobber Net \$126.00**

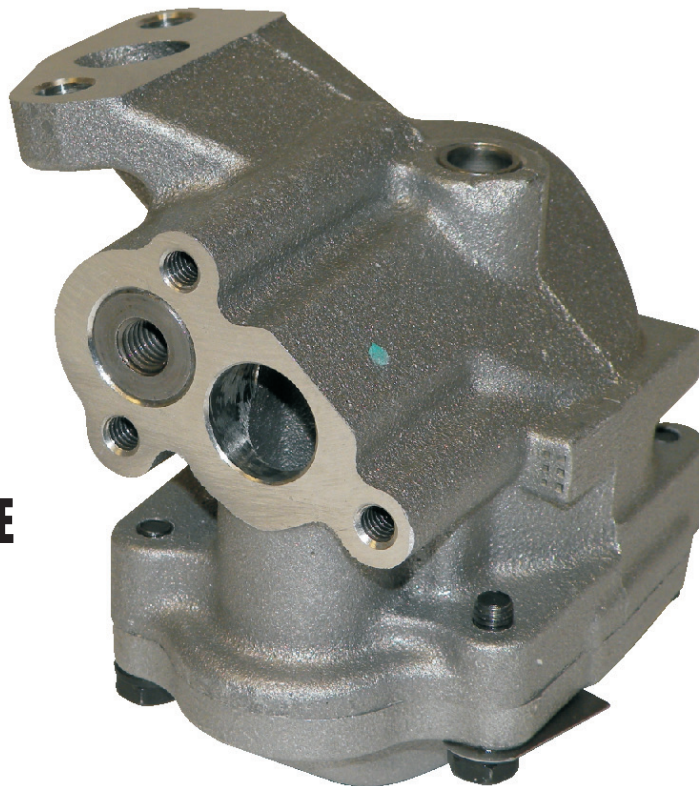

NOTE: The M328 is a High volume oil pump that is a solution for the constant low oil pressure associated with the Ford Truck and Mercury 4.0L engines.

<b>1986-92</b>	<b>FORD TRUCK</b>	<b>2.9-T (177)</b>	<b>1991-00</b>	<b>MAZDA</b>	<b>4016CC OHV</b>
<b>1997-04</b>	<b>FORD TRUCK</b>	<b>4.0-E,K (245) SOHC</b>	<b>2001-04</b>	<b>MAZDA</b>	<b>4016CC SOHC</b>
<b>1990-00</b>	<b>FORD TRUCK</b>	<b>4.0-X (245) SOHC</b>	<b>1988-89</b>	<b>MERCURY</b>	<b>2.9 (177)</b>
	<b>1998-08</b>	<b>MERCURY</b>	<b>4.0-E,K (244) SOHC</b>		

**\*\*Always consult catalog listings for detailed applications\*\***

**MEMBER**  
**A.E.R.A**  
**P.E.R.A**

**“Quality in all we do.”**

Melling Engine Parts • P.O. Box 1188 • Jackson, MI 49204  
(517) 787-8172 • Fax (517) 787-5304 • [www.melling.com](http://www.melling.com)

**MEMBER**  
**A.A.I.A.**  
**M.E.M.A.**